

Double catch pin with spacer



Description

Double steel catch pin with spacer and elongated screw holes. It can be adjusted with a 5 mm Allen wrench.

Application

Suitable for monobloc systems with soffit and 35 mm useful clearance between window and shutter.

NB. Working tolerances can be compensated by adjusting the pins before fastening the centre screw and tightening the two side screws.

- Used in combination with standard or curved closing hooks.

Mounting

Use three 4x30 mm screws with thread suitable for the shutter material.

It must be attached to the lower rail of the window, possibly resting on the sill.

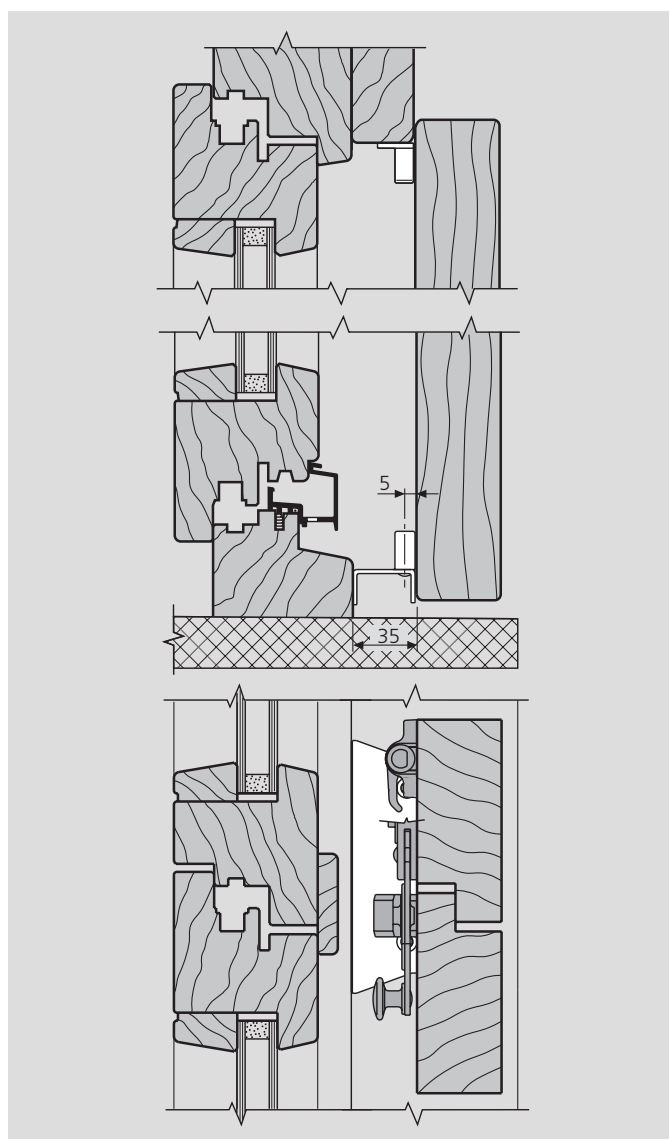
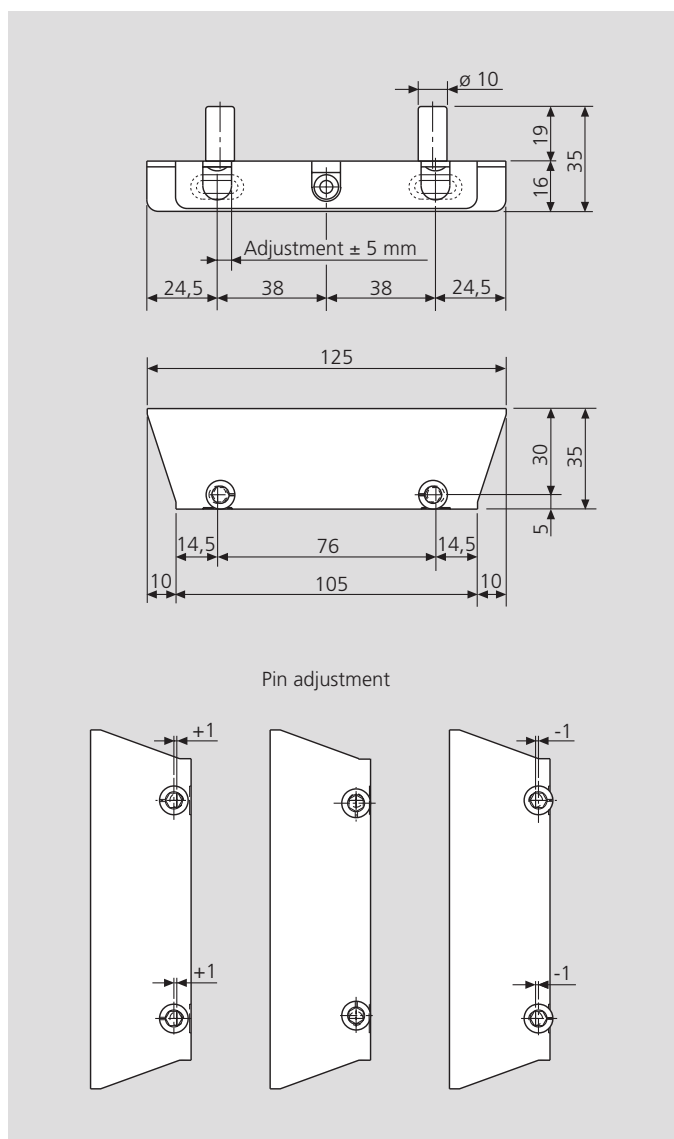

Order specifications

Black finish

Code
H00901.31.93

Bichromated finish

Code
H00901.31.04